

**ACE**  
MACHINERY

# RL1000

MINI SKID STEER



Engine Model: KUBOTA D1703  
Gross Power: 24.7HP(18.2KW)  
Operating Weight: 3924LBS(1780KG)

Unique Design, Exceptional Performance,  
And Outstanding Efficiency.

# RL1000

## MINI SKID STEER

DIMENSIONS (STD)		U.S.(in)	METRIC
A	Operating height, max std. bucket	117in	2980mm
D	Overall length of machine, std. bucket	117in	2980mm
E	Overall length of loader, no attachment	83.5in	2120mm
C	Overall machine height	56in	1420mm
	Machine weight (no attachment, fluids full)	3306lb	1780kg
	Operating capacity		
	35% tipping capacity	1067lb	484kg
	Tipping capacity	3051lb	1384kg
B	Hinge pin height, max	87in	2220mm
F	Wheelbase/track length	46.5in	1180mm
I	Ground clearance, min		
	Center	5.7in	145mm
J	Angle of departure	33°	
P	Overall width	36.7in	932mm
Q	Total track width	36.2in	920mm
R	Track width	7in	180mm

### POWER

Model No.	Kubota D1703	
Fuel	Diesel	
Gross power rating	24.7hp	18.2kW
Emissions compliance	EPA Tier 4	EU Stage V
Number of cylinders	3	
Displacement	100.5in <sup>3</sup>	1.647L
Bore	3.46 in	87mm
Stroke	3.64 in	92.4mm
Rated speed	2,200rpm	

### OPERATION

Ground drive speed		
Forward/Reverse	4mph	6.5km/h
Ground pressure(ISO/CD 16754)		
9-in(230-mm)tracks	4.5psi	0.31bar

### HYDRAULIC SYSTEM

Auxiliary circuit		
Gear pump		
Flow rate (pump #1)	15gpm	56.8L/min
Pressure	3,190psi	220bar
Dual hydrostatic ground drive pumps		
Flow rate	22.1gpm	83.6L/min
Pressure	3,190psi	220bar

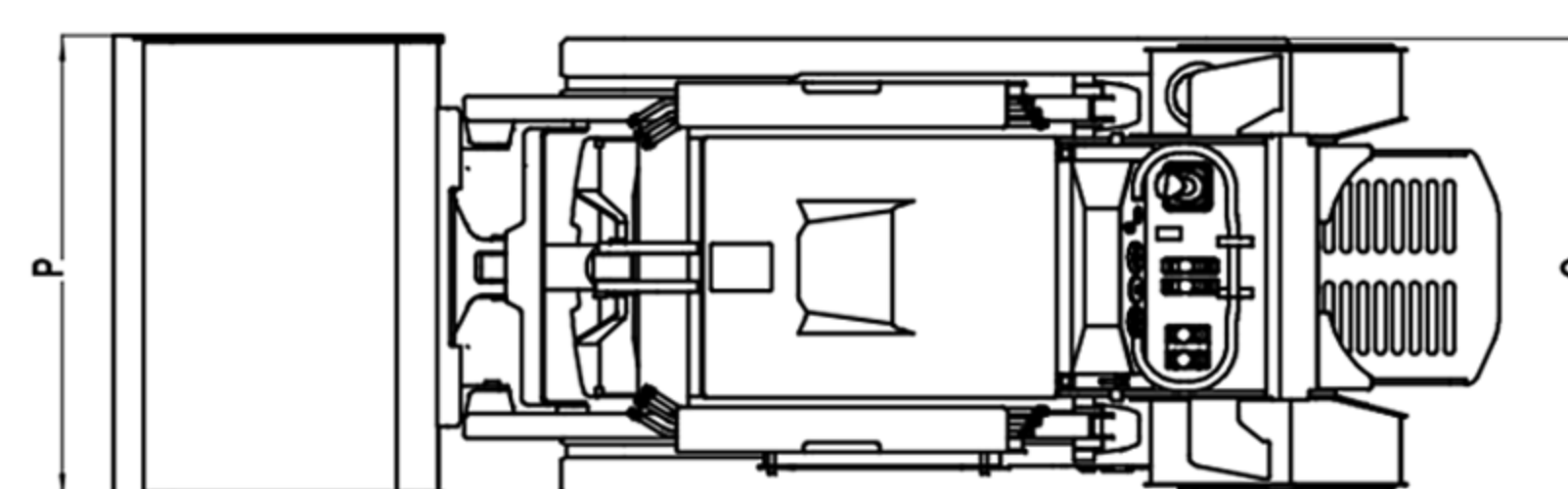
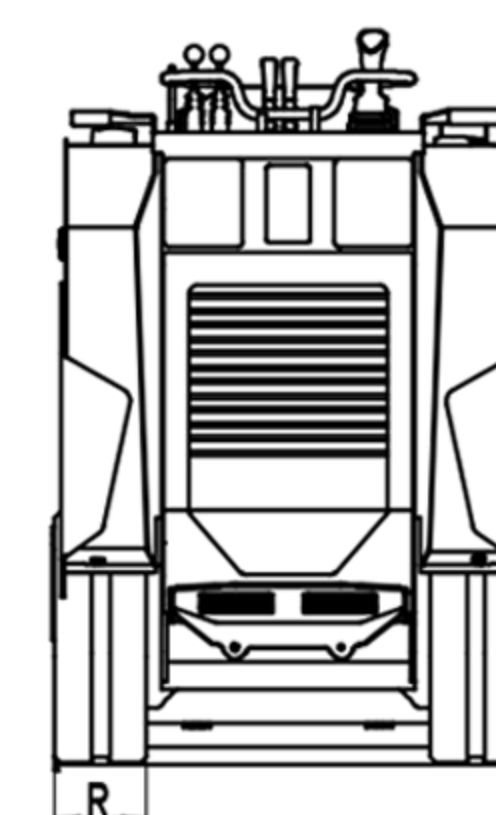
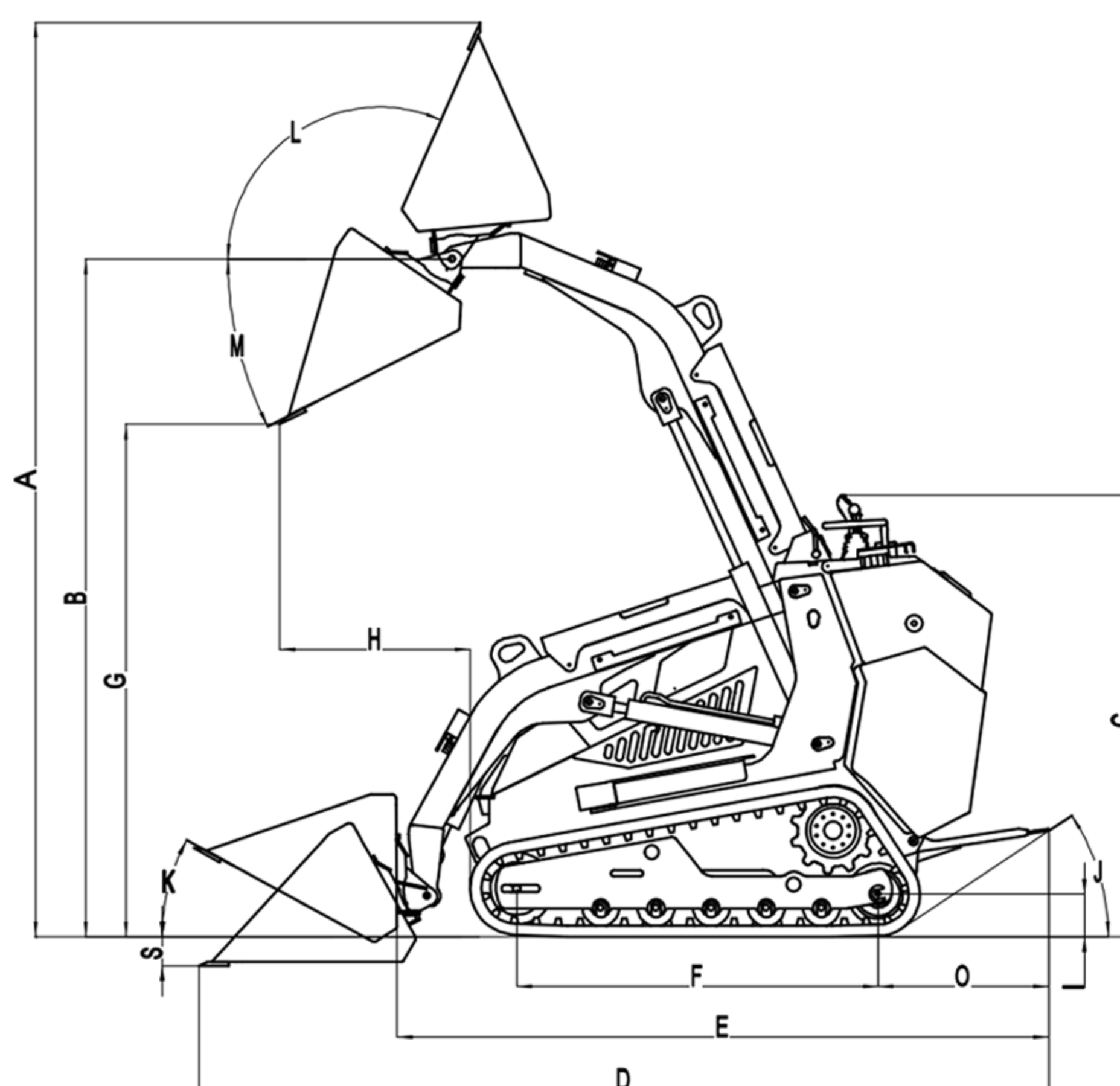

### FLUID CAPACITIES

Fuel tank capacity	10.5gal
Lubricating oil capacity	1.3gal
Hydraulic reservoir capacity	9.5gal

### BATTERY

SAE reserve capacity rating	110min
SAE cold crank @ 0°F (-18°C)	800amps
Electrical system	12V

## ACE MACHINERY CORP

TEL:214-666-5011

FAX:214-550-1132

EMAIL:office@acemachinerycorp.com

WEB:www.acemachinerycorp.com

**ACE**  
MACHINERY

**ACE**  
MACHINERY

# RL2700

BUGGY



Engine Model: KUBOTA D1703  
Gross Power: 24.7HP(18.2KW)  
Operating Weight: 2778LBS(1260KG)

High capacity in a compact design.

# RL2700

## BUGGY

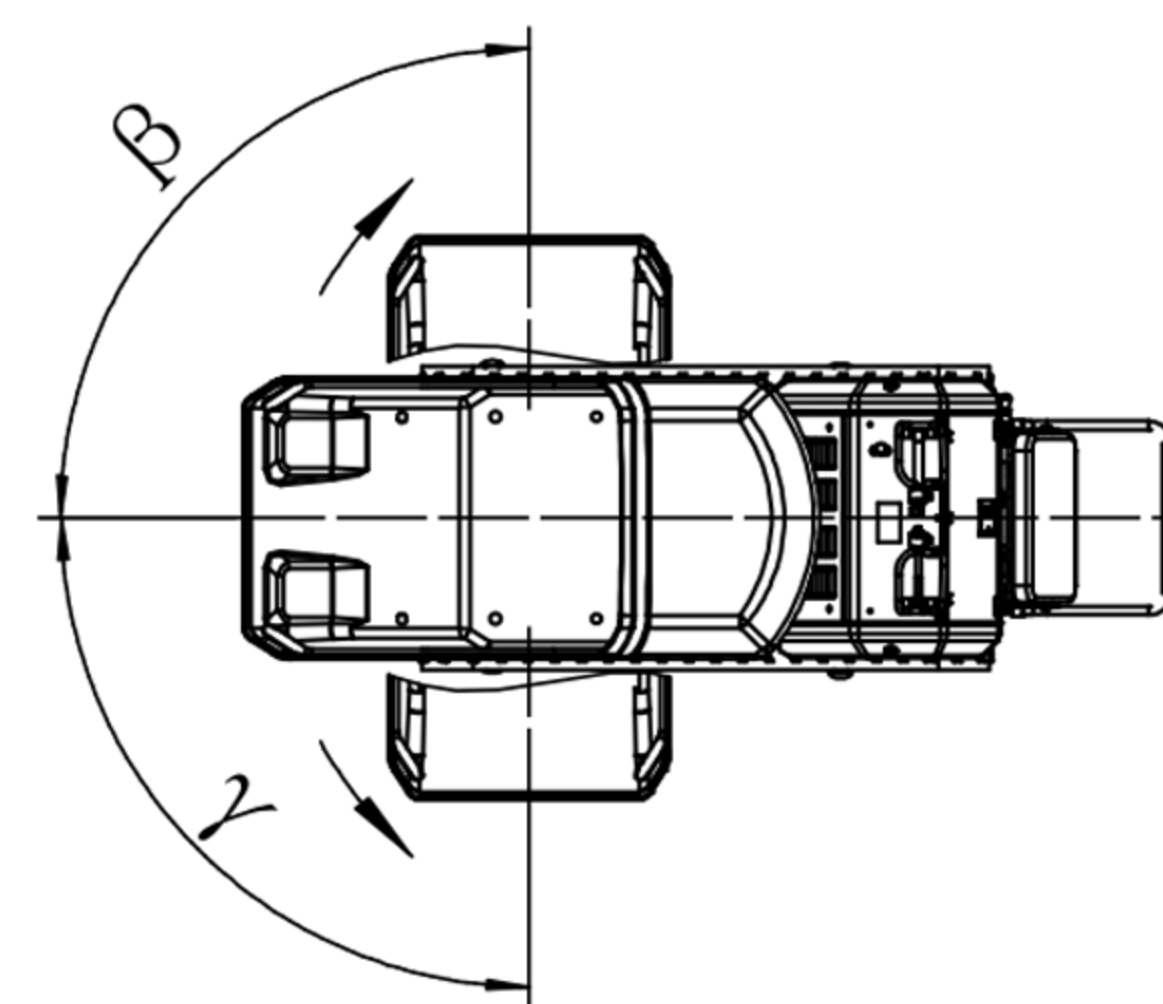
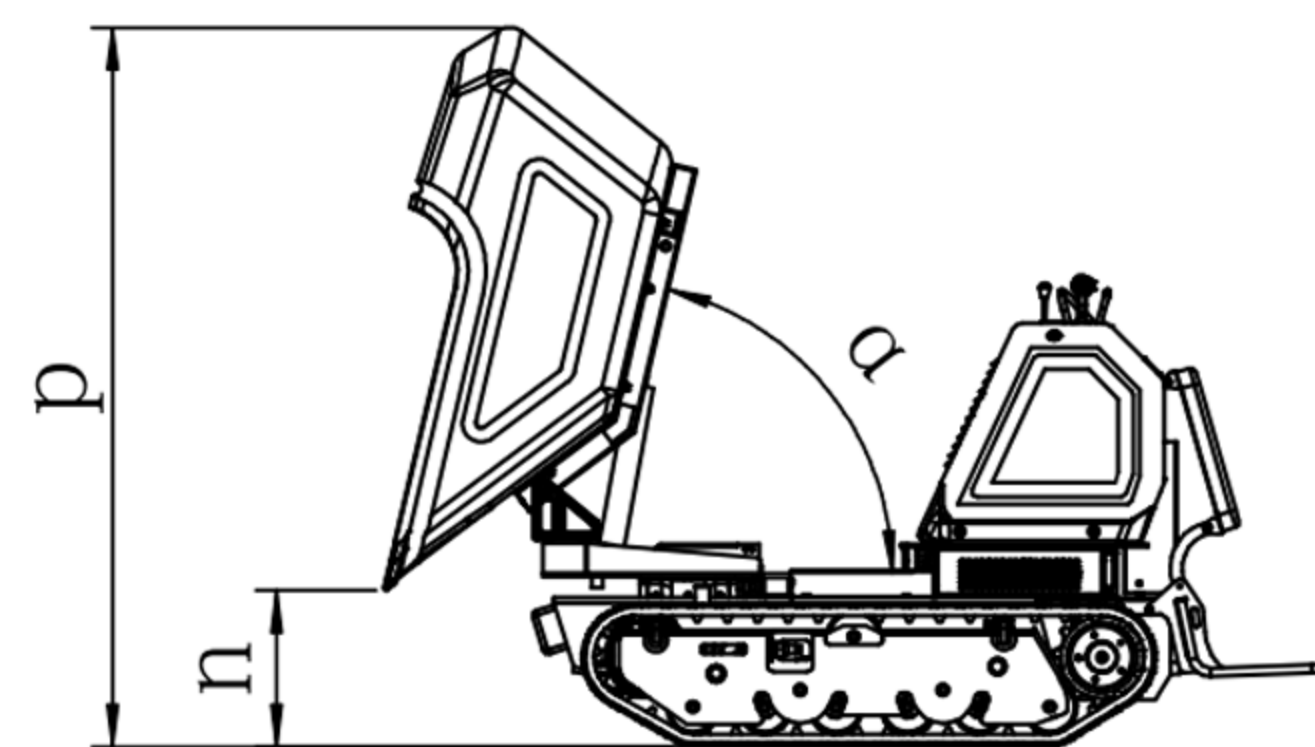
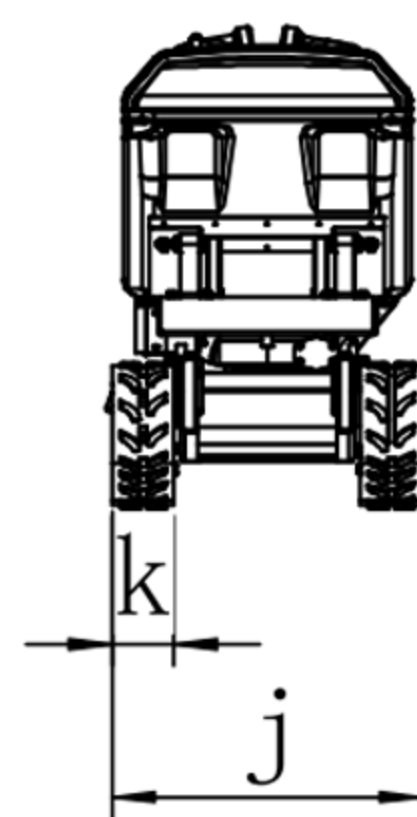
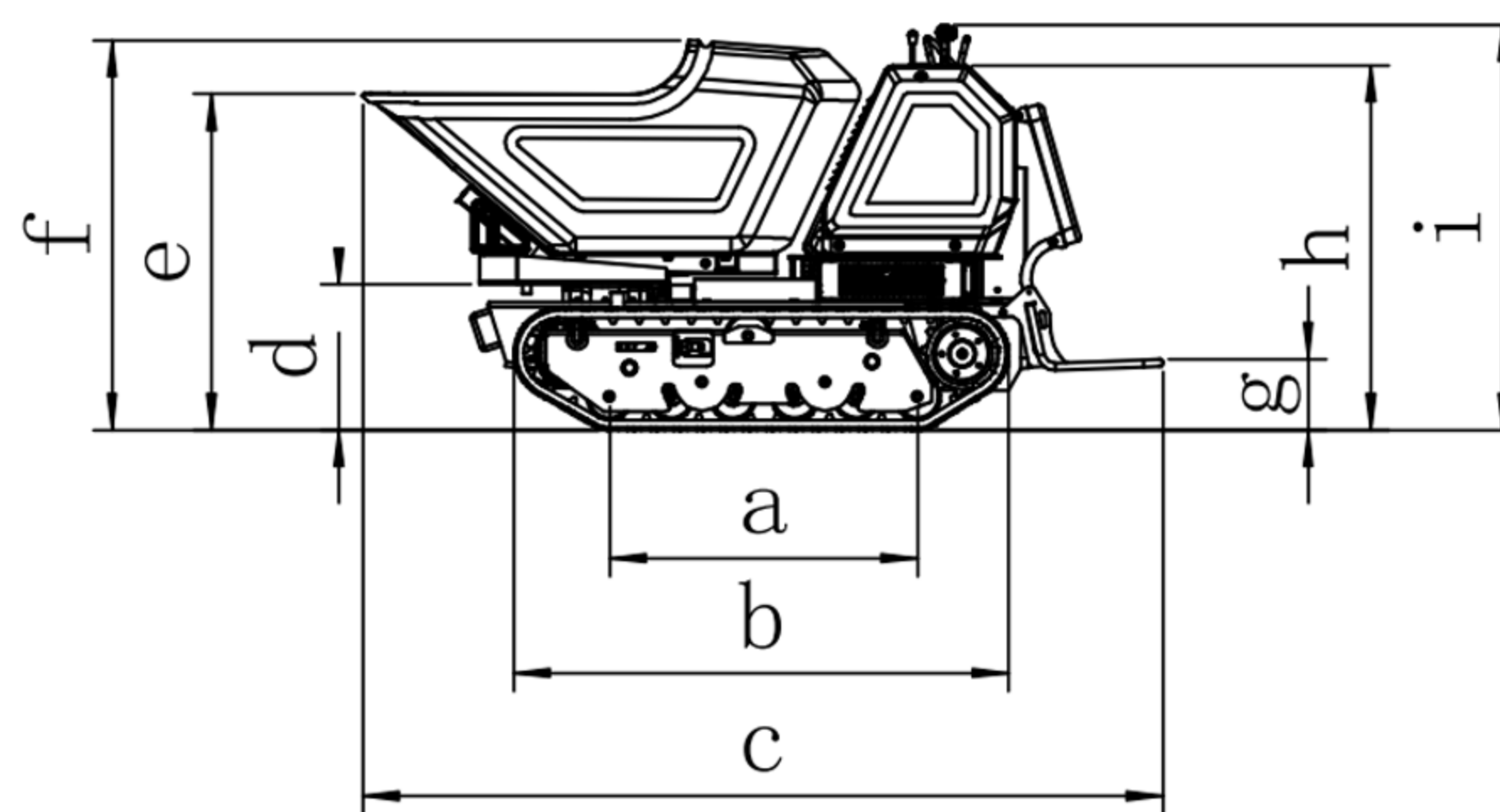

DIMENSIONS (STD)		U.S.(in)	METRIC(mm)
a	Wheelbase	41.7	1060
b	Total length of track	66.5	1690
c	Length	107.8	2740
d	Track height	16.5	420
e	Front end of tipping bucket height from ground	45.4	1155
f	Back end of tipping bucket height from ground	52.9	1345
g	Platform ground clearance	9.4	240
h	Control platform height from ground	49.4	1255
i	Operation handle height from ground	53.3	1355
j	Width	35.4	900
k	Track width	7.08	180
m	Tipping bucket width	32.8	835
n	Unloading front-end height from ground	18.1	460
p	Unloading back-end height from ground	83.4	2120
$\alpha$	Tipping bucket unloading angle	81°	
$\beta$	Tipping bucket right rotation angle	90°	
$\gamma$	Tipping bucket left rotation angle	90°	

MAIN SPEC	U.S.(in)	METRIC
Max Load Capacity	2700 lbs	1225 kg
Weight	2778 lbs	1260 kg
Tub Material	Polyethylene	
Tub Volume	17.7 ft <sup>3</sup>	0.5 cbm
Tracks/Tires	Rugged aramid corde	

POWER		
Model No.	Kubota D1703	
Fuel	Diesel	
Rated power	24.7 hp	18.2 kw
Emissions compliance	EPA Tier 4	EU Stage V
Number of cylinders	3	
Displacement	100.5 in <sup>3</sup>	1.647 L
Cylinder bore and stroke	3.43 * 3.64 in	87*92.4 mm
Rated speed	2,200 rpm	

HYDRAULIC SYSTEM		
Auxiliary circuit		
Gear pump		
Flow rate (pump #1)	4.6 gpm	17.6 L/min
Pressure	3,625 psi	250 bar
Dual hydrostatic ground drive pumps		
Flow rate	15.0 gpm	57.2 L/min
Pressure	3,625 psi	250 bar

OPERATION	U.S	METRIC
Ground drive speed		
Forward/reverse	4 mph	6.5 km/h
Ground pressure	ISO/CD 16754	

FLUID CAPACITIES	U.S	METRIC
Fuel tank capacity	6.3 gal	24 L
Discharge Height	18 in	
Lubricating oil capacity	1.8 gal	7 L
Hydraulic reservoir capacity	3.6 gal	13.6 L

BATTERY	
SAE reserve capacity rating	110 min
SAE cold crank @ 0°F (-18°C)	800 amps
Electrical system	12 V

## ACE MACHINERY CORP

TEL:214-666-5011

FAX:214-550-1132

EMAIL:office@acemachinerycorp.com

WEB:www.acemachinerycorp.com

**ACE**  
MACHINERY